

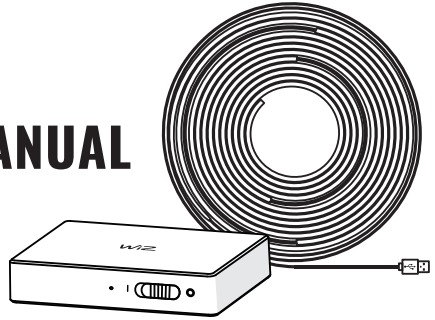

HDMI SYNC BOX WITH TV BACKLIGHT USER MANUAL

9290046678
9290046679



www.wizconnected.com
©2025 Signify Holding
Signify

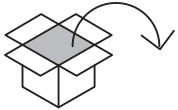

HDMI sync box x1

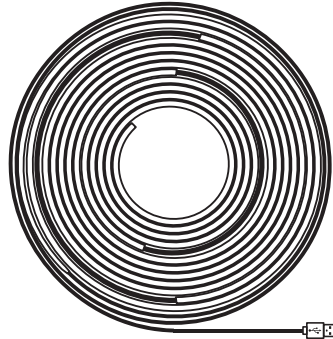

TV backlight strip x1

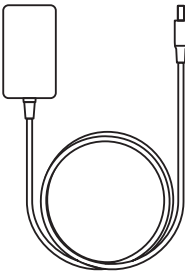

Power adapter x1

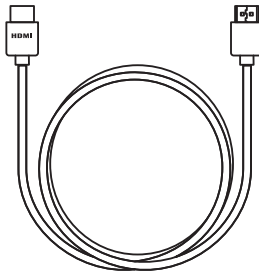

HDMI cable x1

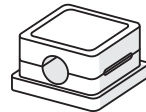

Clip A x2

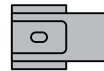

Clip B x10

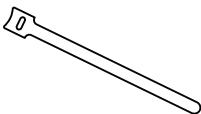

Strap x2

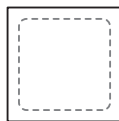

Alcohol pad x1



User manual A & B

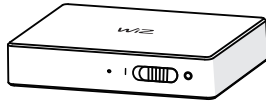

LED indicator ON OFF

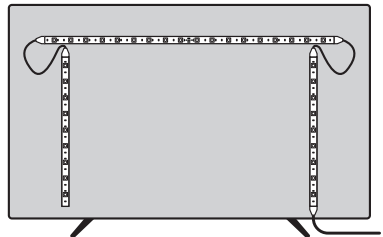
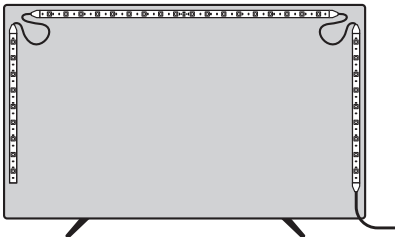
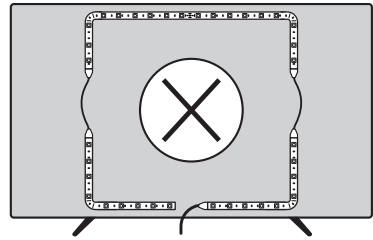
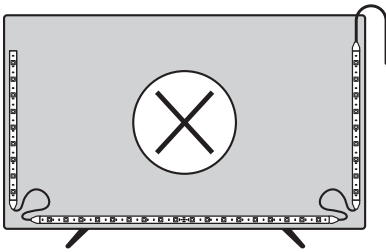
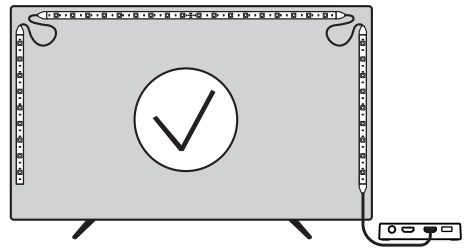
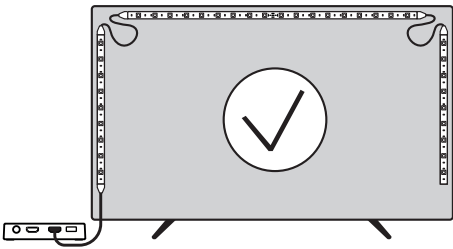
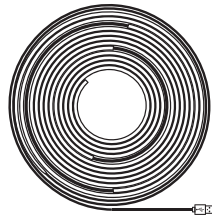
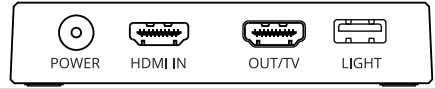
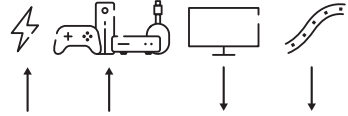
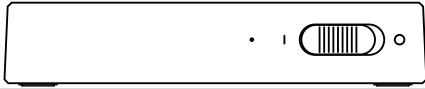



1

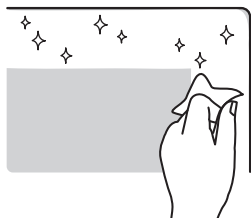

2

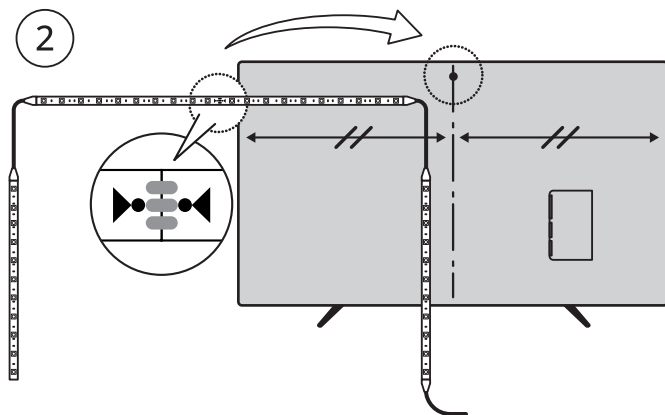

3

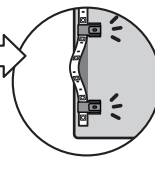
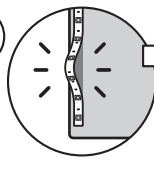
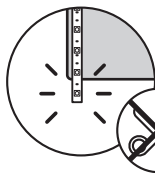
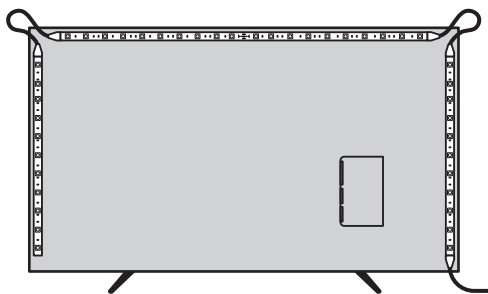

4

Clip A

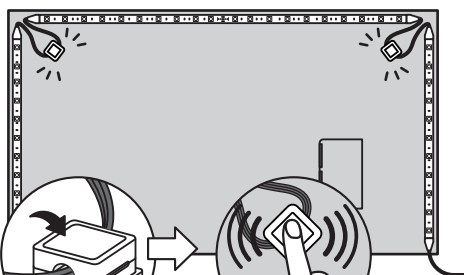
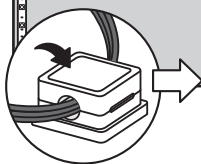
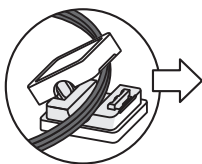
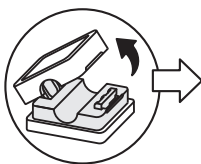

5

Clip B

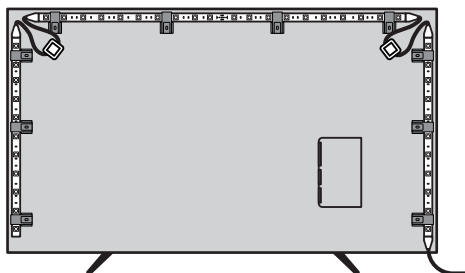
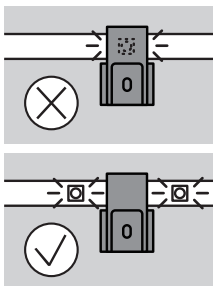

6

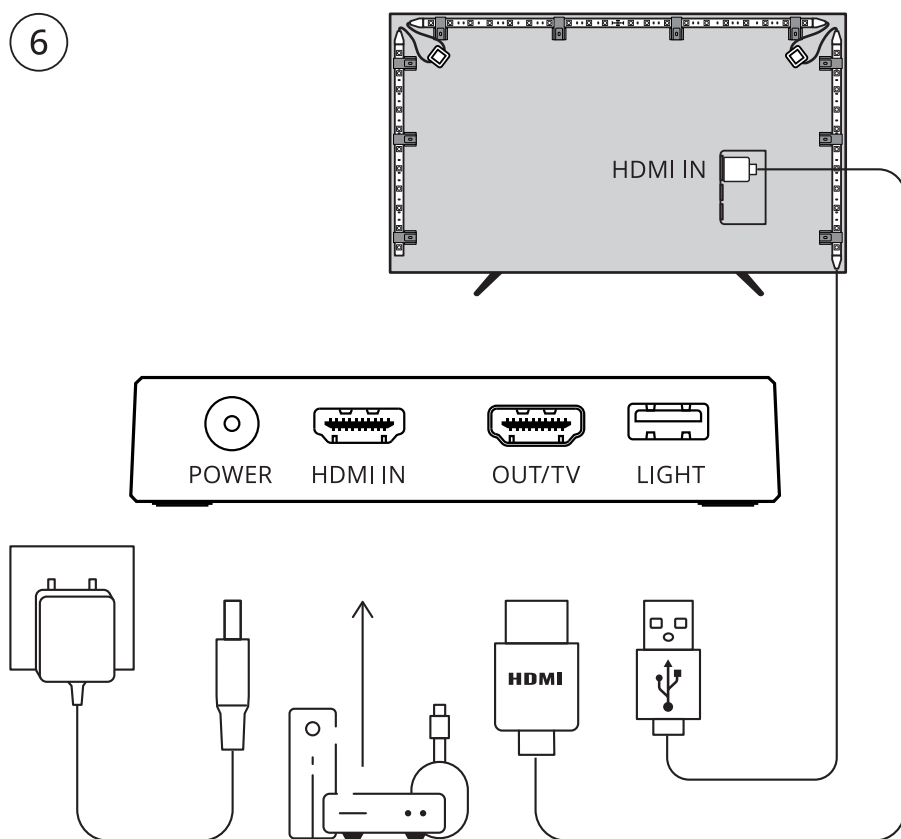

Supports HDMI 2.0 and video format up to 4K at 60Hz, HDR10+, Dolby Vision.

It does NOT support 2560 x 1440 resolution.



1. Place the sync box close to the speakers so its embedded microphone can detect the audio.
2. You can add an HDMI switcher to connect multiple media devices.



1



2

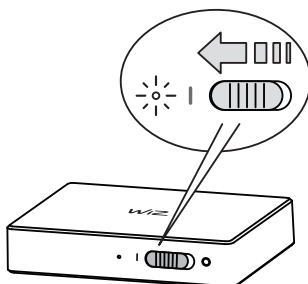

3

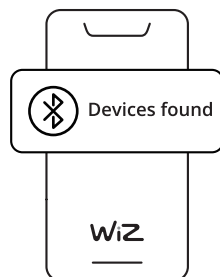

If your home has 2 Wi-Fi networks, make sure your phone is connected to the 2.4 GHz network (NOT the 5 GHz network).



A



www.wizconnected.com/support

B

